

### Portable, Ultralight, Affordable

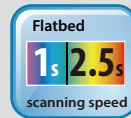
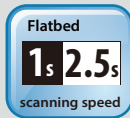

#### Features:

- Ultra slim – 1.8 inches in height and 1.1 kg in weight
- Scans an A5-size page needs only 1 second (color, 300 dpi)
- Brightness and contrast controls to customize color output for specific applications
- Hi-speed USB 2.0 interface
- Includes TWAIN Driver
- Scan & send images to pre-defined destination with a single press

#### Speed, simplicity and advanced imaging for workgroup applications

Avision is proud to introduce its slim scanner series. The FB15 is one of slim scanner series which support document up to A5 size. Based on the innovative CIS(Contact Image Sensor) technology, the FB15 is only 1.8 in. height and weights a mere 1.1 kg.

Despite its small footprint, the FB15 is big on resolution. With a true optical resolution of 1200 dpi and color depth of 48-bits, the FB15 is able to reproduce image in fine detail and subtle shade.

#### No Warm Up Needed and Fast Scan Speed

The LED illumination system not only saves power, it doesn't require any warm up time. The FB15 is ready to go as soon as you turn it on. It's fast too! It only takes 1second to scan an A5 size document.

#### What we have bundled

The Avison FB15 scanner comes with TWAIN driver and is also bundled with full version of exclusive Avison Button Manager V2 and ScanSoft PaperPort SE 14

#### Avison's Button Manager V2

-Completes your scan with a single step



Avison's Button Manager V2

Button Manager V2 makes it easy for you to scan and send your image to your favorite destinations with a press one button. Now the new version comes with an innovative feature to let you scan and automatically upload the scanned document to popular cloud repositories such as Google Docs, Microsoft SharePoint, or FTP. In addition, the iScan feature allows you to insert the scanned image or recognized text after optional OCR (Optical Character Recognition) process to your text editor such as Microsoft Word to get your job done easily and quickly.

# Avision FB15 A5 Flatbed Scanner

## Nuance PaperPort SE14

- The Professional Choice to Organize and Share Your Documents



The PaperPort SE14 main screen

PaperPort SE 14 is Nuance's most popular scanning and document management solution, carefully designed specifically for home office use. Part traditional file cabinet, part digital-document desktop, PaperPort SE 14 is the fastest and easiest way to scan, share, search, and organize your documents. Additionally, PaperPort SE 14 now delivers anytime-anywhere access to your most important files however it's convenient for you – using a PC, Mac, iPhone, iPad, or Android device.

## Advanced TWAIN Driver



Avision's easy-to-use TWAIN driver provides various useful features such as auto color detection, color matching, to enhance your image quality and improve your productivity.

### Color Matching

Use the default parameters (ICC profile) to get the accurate colors of your pictures.



With color adjustment



Without color adjustment

## Multi-stream

Scan one image and show 2~3 images in different image modes in one time.

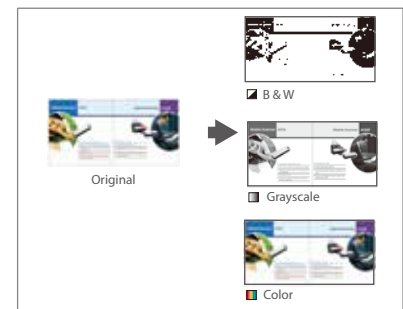

## Color Drop Out

Not only R/G/B 3 channel color drop out, but any specific color can be selected as a color filter.

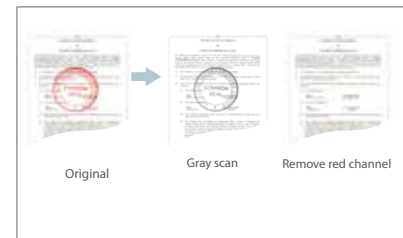

and more function...



## Avision FB15 Product Specifications

Scanning Mode:	Flatbed
Scanning Technology:	CIS
Max. Document Size:	219.5 mm x 182 mm ( 8.6 in x 7.2 in )
Scanning Speed: (at 300 dpi, A5 size)	1 sec./ 2.5 sec.(Include Backhome)
Optical Resolution:	1200 dpi
Output Resolution:	75, 100, 150, 200, 300, 400, 600, 1200 dpi
File Format Outputs:	B&W, grayscale, 24-bit color
Bundle Software:	Avision Button Manager, Nuance PaperPort SE 14
Interface Support/ Driver:	USB 2.0 / TWAIN
Electrical Requirements:	Input: 100-240 VAC, 50/60 Hz Output: 12V, 1.25A
Power Consumption:	Operating – 10 W Ready – 4 W Sleep – 2 W Off – 0.3 W
Environmental Factors:	Operating temperature: 10°C to 35°C (50°F to 95°F) Operating humidity: 10% to 85%
Acoustical Noise:	Standby: <45 dB Operating: <50 dB
Dimensions:	Max.: 277 x 332 x 308 mm (10.91 x 13.07 x 12.13 in.) Min.: 277 x 286 x 46 mm (10.91 x 11.26 x 1.81 in.)
Weight:	1.1 kg ( 2.4 lbs )
Recommended Daily Volume:	Up to 2,500 pages per day

We have endeavored to ensure that the information in this manual is accurate and that Avision is not responsible for printing or typographical errors. The above configurations are for reference only. The actual configuration (software, hardware) should be compiled with the specification described in the manual. Avision Inc. owns the intellectual property rights of the product outlook and design and the product outlook and design are subject to change. Avision Inc. reserves the right to the interpretation of the product description. Avision, Inc. All rights reserved. Other company and product names mentioned in the document are trademarks of their respective companies. Wherein the third party product is for reference only and Avision does not warrant these products nor is responsible for the efficiency or use of these products.

## System Requirements

CPU:	Intel® Core 2 Duo or higher
Memory:	1GB (32bit Windows) 2GB (64bit Windows)
DVD-ROM:	DVD ROM Drive
USB:	USB2.0 Port (USB 1.1 supported)
Windows® Operating System:	Windows® 11, 10, 8, 7

## Contents

FB15 Scanner
Quick Guide
USB 2.0 Cable
CD-ROM includes:
-Scanner Driver (TWAIN Driver)
-Button Manager
-Nuance PaperPort SE 14



**Avision**  
www.avision.com