

Powerful performance, affordable printing

The TASKalfa PA4500ci is the ideal A4 colour printer if your business is searching for a solution that offers low running costs while providing unprecedented productivity and durability. Built with a compact design, this versatile device offers optional Wi-Fi Direct functionality for easy user connection.

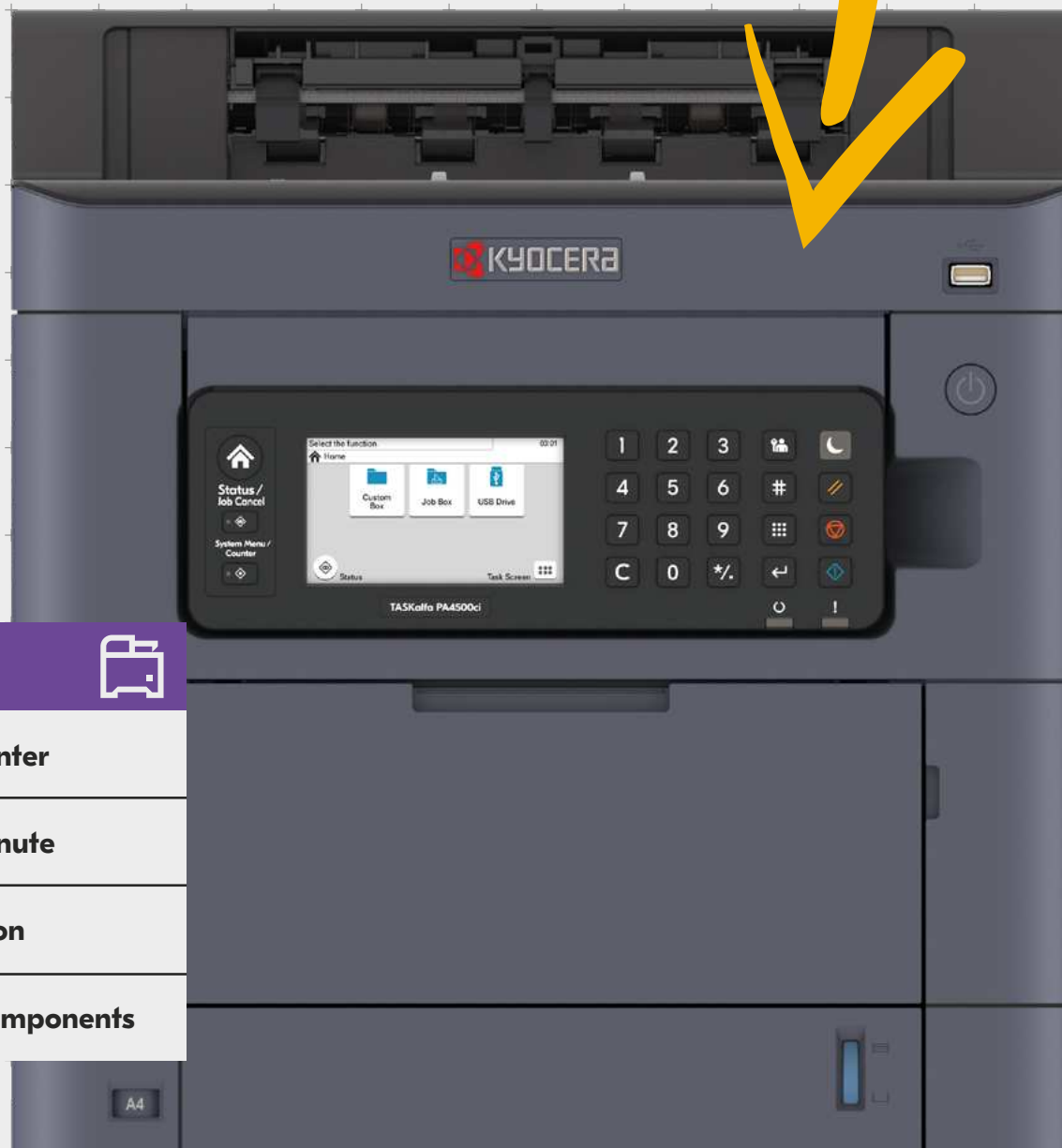

TASKalfa PA4500ci



A4 colour and b/w printer

Up to 45 pages per minute

Low power consumption

Made with long-life components

A4

Specifications

GENERAL

KYOCERA TASKalfa Laser Colour Multifunctional
HyPAS™ solution platform
Operation panel: 109.2 mm (4.3-inch) full-colour touch panel display
Type: Desktop
Engine speed Simplex: Up to 45 pages A4 per minute
Engine speed Duplex: Up to 37 pages A4 per minute
Resolution: 1,200 × 1,200 dpi print at reduced speed
Warm-up time: Approx. 20 seconds or less
Time to first print: Approx. 5.1/6.2 seconds or less in Monochrome/Colour
CPU: ARM Cortex-A9 Dual core 1.2GHz
Memory: Standard 1GB
Max. 3GB + 64GB SSD / 256GB SSD / 512GB SSD
Standard interfaces: USB 2.0 (Hi-Speed), 2 x USB Host Interface, Gigabit Ethernet (10BASE-T/100BASE-TX/1000BASE-T), optional Wireless LAN (IEEE 802.11b/g/n), 1 x eKUIO slot for optional devices other than FAX, Slot for optional SD Card
Integrated accounting: 100 department codes
Dimensions (W x D x H): Without packaging: 394 × 531.5 × 455 mm (without protrusions)
Weight: Without packaging: Approx. 34 kg (with bundled toner)
Power source: AC 220 ~ 240 V, 50/60 Hz
Power consumption:
Printing: 593.8 W
Ready mode: 12.8 W
Sleep-mode: 0.5 W (default)

PAPER HANDLING

All paper capacities quoted are based on paper thickness of max. 0.11 mm. Please use paper recommended by KYOCERA under normal environmental conditions.

Input capacity: Multi-purpose tray: 100 sheets (75 g/m² equivalent), 110 sheets (64 g/m² equivalent); 60 – 220 g/m²; A4, A5, A6, B5, B6, Letter, Legal, Folio, Custom (70 x 140 to 216 x 356 mm), Banner paper up to 1220 mm; Standard universal paper cassette: 550 sheet with 75 g/m², 600 sheet with 64 g/m²; 60 – 220 g/m²; A4, A5, A6, B5, B6, Letter, Legal, Folio, Custom (105 x 140 to 216 x 356 mm); Max. input capacity with options: 2,850 sheets with 75 g/m², 3,110 sheets with 64 g/m²
Duplex: Standard duplex unit; 60–163 g/m²; A4(Legal) - A6R(StatementE)
Output capacity: 500 sheets (Equivalent to 80 g/m²) face down with paper full sensor

PRINT FUNCTIONS

Controller language: PRESCRIBE
Emulations: PCL6 (5c/XL), KPDL3 (PostScript 3 compatible), PDF, XPS, Open XPS, TIFF, JPEG, URF, PWG Raster, PCLm
Operating systems: All current Windows operating systems, MAC OS X Version 10.9 or higher, Chrome OS, Linux, as well as other operating systems on request
Fonts/barcodes: 93 outline fonts (PCL6, KPDL3), 4 fonts (Calibri), 4 fonts (Cambria), 1 Bitmap font, 45 types of one-dimensional barcodes, 1 type of two-dimensional barcode (PDF417)
Print features: Encrypted PDF Direct Print, IPP printing, e-mail printing, WSD print, secure printing via SSL, IPsec, SNMPv3, quick copy, proof and hold, private print, job storage and job management functionality
Mobile printing support: KYOCERA Mobile Print app for iOS and Android, AirPrint, Mopria, Microsoft Universal Print, Wi-Fi Direct (Opt)

SECURITY FEATURES

Secure Boot3, Run-time Integrity Check3, Allowlisting, TLS 1.3, IPsec, HTTPS, SNMPv3, "Confidential printing" with PIN code request, encrypted PDF direct printing, Security watermark, IPP over TLS, Enhanced WSD (TLS), network authentication (Kerberos, NTLM, 802.1x), restriction of the user group, through user login management, IP filters, port number restrictions, Blocking interfaces, security Quick setup, adjustable administrator authentication for firmware updates, SIEM support (SysLog), SCEP, OSCP & CRL4, free activation of "Data Security Kit" functionality (e.g. data encryption, overwriting data no longer required) when installing an optional Hard drive, data cleaning (resetting in the device stored information to factory settings, e.g. B. System settings or stored in a user box data), optional: TPM (Trusted Platform Module)

CONSUMABLES

Average continuous toner yield in accordance with 5% coverage
Toner Kit:
TK-5425K: Microfine toner black for 20,000 pages A4
TK-5415Y, TK-5415M, TK-5415C: Microfine toner Yellow, Magenta, Cyan for 13,000 pages A4;
Starter toner black 8,000 pages and Yellow, Magenta and Cyan 6,000 pages in A4

OPTIONS

PF-5150 Paper feeder: Max. 550 sheet with 75 g/m², 600 sheet with 64 g/m², 60 - 220 g/m², A5R - Legal, 92.1 × 165.1 (Com6)
Memory upgrade: 1 GB/2 GB
Storage Devices for easy document management:
HD-17 SSD hard disk: 64GB
HD-18 SSD hard disk: 256GB
HD-19 SSD hard disk: 512GB
Scan Extension Kit (A): Scan to searchable PDF (embedded OCR) or to MS Office (docx, xlsx, pptx), HD or SD card is needed.
CB-5150S: Steel cabinet (47cm)
CB-5150H: Wooden cabinet (50cm)
CB-5150L: Wooden cabinet (37cm)
CB-5150B: Baseplate for configuration including 4 x PF-5150
Card Reader Holder 12

SECURITY

UG-33: ThinPrint support
UG-35: TPM (Trusted Platform Module)
USB IC Card Reader + Card Authentication Kit (B): Support for various authentication keys available.
Optional interface:
IB-37: Wireless LAN (802.11a/b/g/n/ac) with Wi-Fi Direct
IB-38: Wireless LAN (802.11b/g/n) with Wi-Fi Direct
IB-50: Gigabit Ethernet 10BASE-/100BASE-TX/1000BASE-T
IB-51: Wireless LAN Interface (802.11b/g/n)
Product Library 14: Installation DVD

Specifications and design are subject to change without notice. For the latest on connectivity visit kyoceradocumentsolutions.us. TASKalfa, PRESCRIBE, Kyocera Net Manager, Kyocera Net Viewer, Kyocera Device Manager, PDF Direct Print, Command Center RX, and KX Driver are trademarks of The Kyocera Companies. Mac OS and AirPrint are trademarks of Apple, Inc. Windows is a trademark of Microsoft, Inc. All other trademarks are the property of their respective owners.

HyPAS™



KYOCERA Document Solutions Partner

AGU2023PA4500ci/VER1.0

KYOCERA Document Solutions Europe B.V.
Beechavenue 27, 1119 RA, Schiphol-Rijk
Tel +31 (0) 20-654-0000 – Fax +31 (0) 20-653-1256
www.kyoceradocumentsolutions.eu – info@deu.kyocera.com



* KYOCERA Document Solutions does not warrant that any specifications mentioned will be error-free. Specifications are subject to change without notice. Information is correct at time of going to press. All other brand and product names may be registered trademarks or trademarks of their respective holders and are hereby acknowledged.
** Depending on the country